

WYKAZ PRĘTÓW NA JEDEN STROF

5000	N7 #8 I. = 1750 sr12.59 A <sub>+</sub> -N <sub>11</sub>	95	5000	N13 #12 I. = 3800 sr1.48 A <sub>+</sub> -N <sub>11</sub>	95	5000	N27 #10 I. = 53500 sr27.20 A <sub>+</sub> -N <sub>11</sub>	95
100	N7 #10 I. = 1750 sr2.4 A <sub>+</sub> -N <sub>11</sub>	95	5000	N14 #10 I. = 7500 sr12.4 A <sub>+</sub> -N <sub>11</sub>	95	5000	N28 #10 I. = 5100 sr2.4 A <sub>+</sub> -N <sub>11</sub>	95
5000	N7 #10 I. = 4600 sr27.2 A <sub>+</sub> -N <sub>11</sub>	95	100	N15 #10 I. = 4350 sr1.4 A <sub>+</sub> -N <sub>11</sub>	95	5000	N29 #10 I. = 4500 sr250 A <sub>+</sub> -N <sub>11</sub>	95
5000	N7 #8 I. = 1950 sr1.568 A <sub>+</sub> -N <sub>11</sub>	95	5000	N16 #10 I. = 1550 sr12.0 A <sub>+</sub> -N <sub>11</sub>	95	5000	N30 #8 I. = 1450 sr12.0 A <sub>+</sub> -N <sub>11</sub>	95
5000	N30 #10 I. = 1950 sr1.568 A <sub>+</sub> -N <sub>11</sub>	95	5000	N17 #8 I. = 1550 sr1.56 A <sub>+</sub> -N <sub>11</sub>	95	5000	N31 #10 I. = 1600 sr2.40 A <sub>+</sub> -N <sub>11</sub>	95
5000	N30 #10 I. = 1950 sr2.4 A <sub>+</sub> -N <sub>11</sub>	95	5000	N18 #8 I. = 2300 sr1.56 A <sub>+</sub> -N <sub>11</sub>	95	5000	N32 #10 I. = 4500 sr2.78 A <sub>+</sub> -N <sub>11</sub>	95
5000	N4 #12 I. = 5700 sr25.1 A <sub>+</sub> -N <sub>11</sub>	95	5000	N19 #10 I. = 2000 sr12.0 A <sub>+</sub> -N <sub>11</sub>	95	5000	N33 #10 I. = 3300 sr2.56 A <sub>+</sub> -N <sub>11</sub>	95
5000	N5 #8 I. = 1350 sr1.9 A <sub>+</sub> -N <sub>11</sub>	95	5000	N20 #10 I. = 2000 sr17.7 A <sub>+</sub> -N <sub>11</sub>	95	5000	N34 #10 I. = 8840 sr2.50 A <sub>+</sub> -N <sub>11</sub>	95
5000	N5 #10 I. = 3200 sr1.82 A <sub>+</sub> -N <sub>11</sub>	95	5000	N21 #10 I. = 750 sr1.4 A <sub>+</sub> -N <sub>11</sub>	95	5000	N35 #10 I. = 8840 sr2.50 A <sub>+</sub> -N <sub>11</sub>	95
5000	N7 #12 I. = 5600 sr2.65 A <sub>+</sub> -N <sub>11</sub>	95	5000	N22 #10 I. = 690 sr1.46 A <sub>+</sub> -N <sub>11</sub>	95	5000	N36 #10 I. = 4700 sr2.47 A <sub>+</sub> -N <sub>11</sub>	95
5000	N8 #10 I. = 3800 sr1.95 A <sub>+</sub> -N <sub>11</sub>	95	5000	N23 #10 I. = 2400 sr1.19 A <sub>+</sub> -N <sub>11</sub>	95	5000	N37 #10 I. = 4800 sr2.68 A <sub>+</sub> -N <sub>11</sub>	95
5000	N9 #10 I. = 2600 sr2.81 A <sub>+</sub> -N <sub>11</sub>	95	5000	N24 #10 I. = 3000 sr1.65 A <sub>+</sub> -N <sub>11</sub>	95	5000	N38 #10 I. = 4800 sr2.26 A <sub>+</sub> -N <sub>11</sub>	95
5000	N10 #10 I. = 3400 sr1.36 A <sub>+</sub> -N <sub>11</sub>	95	5000	N25 #8 I. = 2250 sr1.50 A <sub>+</sub> -N <sub>11</sub>	95	5000	N39 #8 I. = 3550 sr1.5 A <sub>+</sub> -N <sub>11</sub>	95
5000	N11 #10 I. = 1650 sr1.6 A <sub>+</sub> -N <sub>11</sub>	95	5000	N26 #10 I. = 1350 sr1.16 A <sub>+</sub> -N <sub>11</sub>	95			
5000	N12 #8 I. = 2550 sr2.98 A <sub>+</sub> -N <sub>11</sub>	95	5000		95			
5000		95	5000		95			

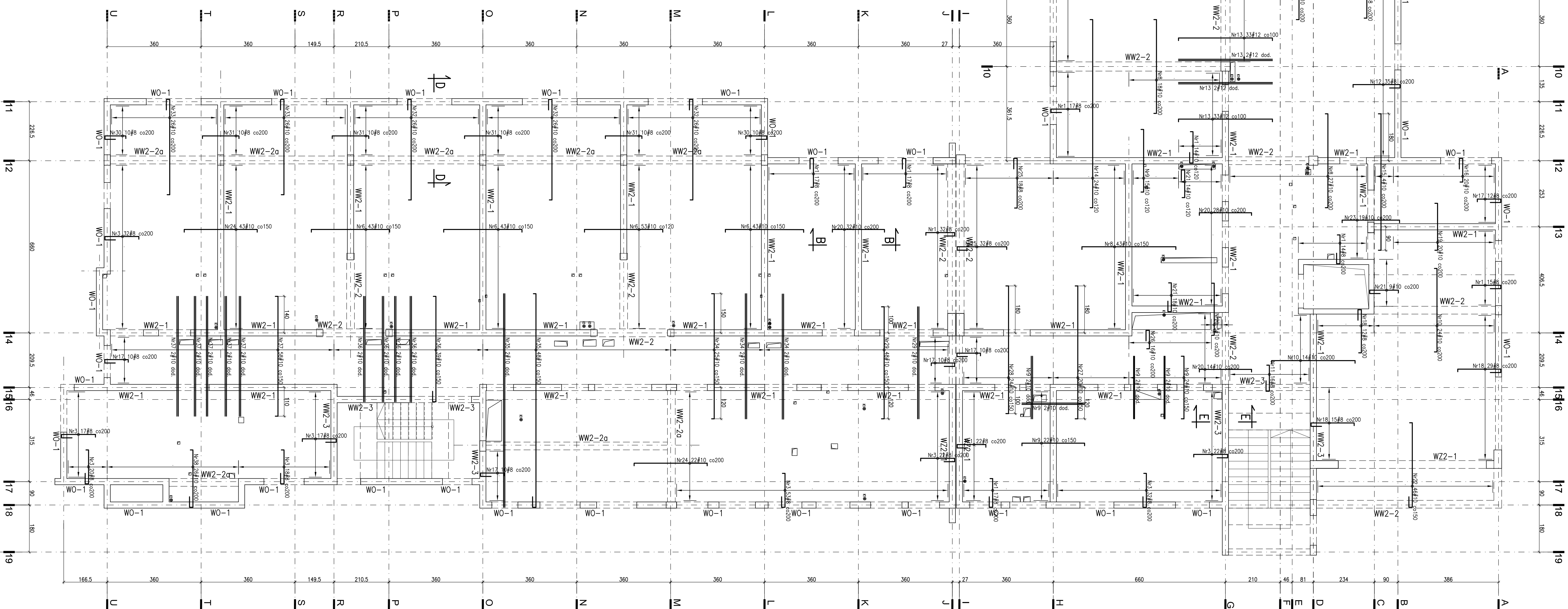

-BETON B30  
-STAL A-III(18500N)-ZAMENNIE BS1500S  
A-I(S3.3S-b)  
A-Q(S10S-b)  
-OTULINa:  
-STROP  $\text{cm} \times \text{cm} = 2 \times 2$

UNIVERSITY OF MICHIGAN LIBRARY

### 1. USTYJOWANIE PRZEJŚĆ I ŚCIĄGNIĘCIE STROPU BROZPAT

RSUNIKAMI ARCHITECTURY I INSTALACJI  
ORAZ K-03 I K-61.

## 2. PRĄTY ZBROJENIA DOLNEGO I GÓRNEGO OBRĘBIE OTWORÓW WCIĄG I DOZBRÓJC

U ZGODNIE Z KRYTERIEM K=55.

**РІЗНОВИДІ К-30.**

- ZESTAWIENIE STALI ZEROWENIOWEJ NR 43

Documentacja techniczna

**DOMU POMOCY SPOŁECZNEJ**  
**1975 ulicy Pawła w Gdyni**

McJannet	McJannet	McJannet
----------	----------	----------





## PROJEKT WYKONAWCZY KONSTRUKCJA

NAME: \_\_\_\_\_

URZĄD MIASTA GOYNI

 The JCI-ACCREDITED PROGRAM  
 81-352 COTINA

Scienze Politiche e della Comunicazione

AUTOREGNA PROACCOMIA ASSICETTURY C.  
04-15A. 1040522VIVA. U. Zambucco 48  
TEL. 022. 601145. 2401152. Fax 022. 602

	6-й класс 6-класс	www.kazpat.ru
ИМЯ НАЗВАНИЕ	ИДЕНТИФИКАЦИОННЫЙ КОД	

[illegible][illegible]

2000-2001		
2001-2002		
2002-2003		
2003-2004		
2004-2005		
2005-2006		
2006-2007		
2007-2008		
2008-2009		
2009-2010		
2010-2011		
2011-2012		
2012-2013		
2013-2014		
2014-2015		
2015-2016		
2016-2017		
2017-2018		
2018-2019		
2019-2020		
2020-2021		
2021-2022		
2022-2023		
2023-2024		
2024-2025		
2025-2026		
2026-2027		
2027-2028		
2028-2029		
2029-2030		
2030-2031		
2031-2032		
2032-2033		
2033-2034		
2034-2035		
2035-2036		
2036-2037		
2037-2038		
2038-2039		
2039-2040		
2040-2041		
2041-2042		
2042-2043		
2043-2044		
2044-2045		
2045-2046		
2046-2047		
2047-2048		
2048-2049		
2049-2050		
2050-2051		
2051-2052		
2052-2053		
2053-2054		
2054-2055		
2055-2056		
2056-2057		
2057-2058		
2058-2059		
2059-2060		
2060-2061		
2061-2062		
2062-2063		
2063-2064		
2064-2065		
2065-2066		
2066-2067		
2067-2068		
2068-2069		
2069-2070		
2070-2071		
2071-2072		
2072-2073		
2073-2074		
2074-2075		
2075-2076		
2076-2077		
2077-2078		
2078-2079		
2079-2080		
2080-2081		
2081-2082		
2082-2083		
2083-2084		
2084-2085		
2085-2086		
2086-2087		
2087-2088		
2088-2089		
2089-2090		
2090-2091		
2091-2092		
2092-2093		
2093-2094		
2094-2095		
2095-2096		
2096-2097		
2097-2098		
2098-2099		
2099-2100		
2100-2101		
2101-2102		
2102-2103		
2103-2104		
2104-2105		
2105-2106		
2106-2107		
2107-2108		
2108-2109		
2109-2110		
2110-2111		
2111-2112		
2112-2113		
2113-2114		
2114-2115		
2115-2116		
2116-2117		
2117-2118		
2118-2119		
2119-2120		
2120-2121		
2121-2122		
2122-2123		
2123-2124		
2124-2125		
2125-2126		
2126-2127		
2127-2128		

Type of purchase	Score
------------------	-------

POZ.4.1, POZ.4.2 STROP NAD PARTEREM	Numer typ
-UKŁAD ZBRÓJENIA GÓRNEGO	K-

1000000000